

## TECHNICAL BULLETIN

[ 1 / 5 ]

[Issue No.] GOT-A-0111-A

[Title] Changes in Rating Plate of GOT and Optional Products

[Date of Issue] March 2017

[Relevant Models] GOT2000 Series, GOT1000 Series

Thank you for your continued support of Mitsubishi Electric Graphic Operation Terminal (GOT).

We have changed the description on the rating plate.

These changes do not affect the general specifications, performance specifications, functions, and external dimensions of the products.

### 1. Details of Change

The following shows examples of the changes.

The descriptions and layout differ depending on the model.

#### 1.1 Rating plate

- (1) The marking method of the Environment-Friendly Use Period mark of China RoHS (modified) has been changed to rating plate from sticker.
- (2) The display position of the manufacturer address and country of origin has been changed.
- (3) The CC-Link IE Field Basic logo has been added to the rating plate of the GT27 and GT25 models.
- (4) The size of the GOT rating plate has been expanded for the GT27 and GT25 models with screen size of 15, 12.1, 10.4, or 8.4 inch.
- (5) The layout on the rating plate has been changed along with the above changes.

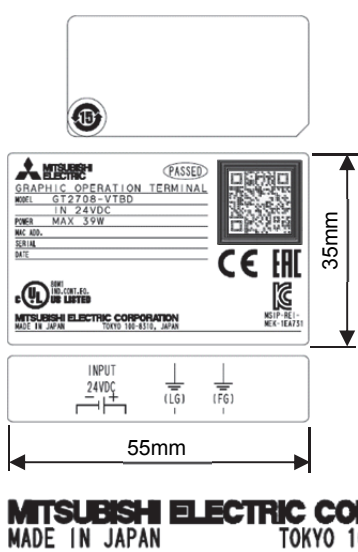
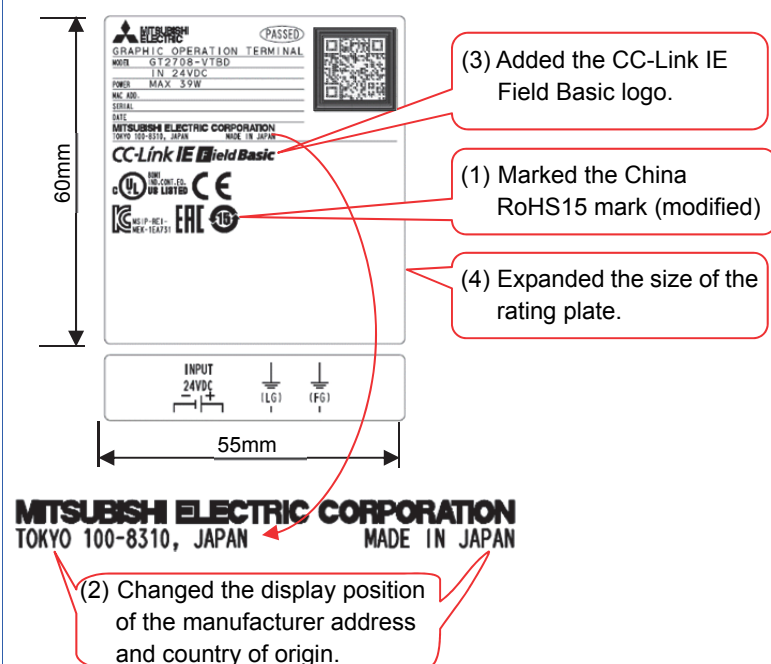
Before	After
 <p>The 'Before' rating plate is 55mm wide and 35mm high. It features a RoHS15 mark, a QR code, and the Mitsubishi Electric logo. The manufacturer address 'MITSUBISHI ELECTRIC CORPORATION, TOKYO 100-8310, JAPAN' is located at the bottom.</p>	 <p>The 'After' rating plate is 55mm wide and 60mm high. It includes the CC-Link IE Field Basic logo, a modified RoHS15 mark, and a QR code. The manufacturer address and 'MADE IN JAPAN' are now positioned in the middle. Callouts (1) through (4) highlight these changes.</p>

[Issue No.] GOT-A-0111-A

**1.2 Rear case of GT2708 and GT2508**

(6) The position of vertical installation arrow mark has been changed for GT2708 and GT2508 along with the change (4).

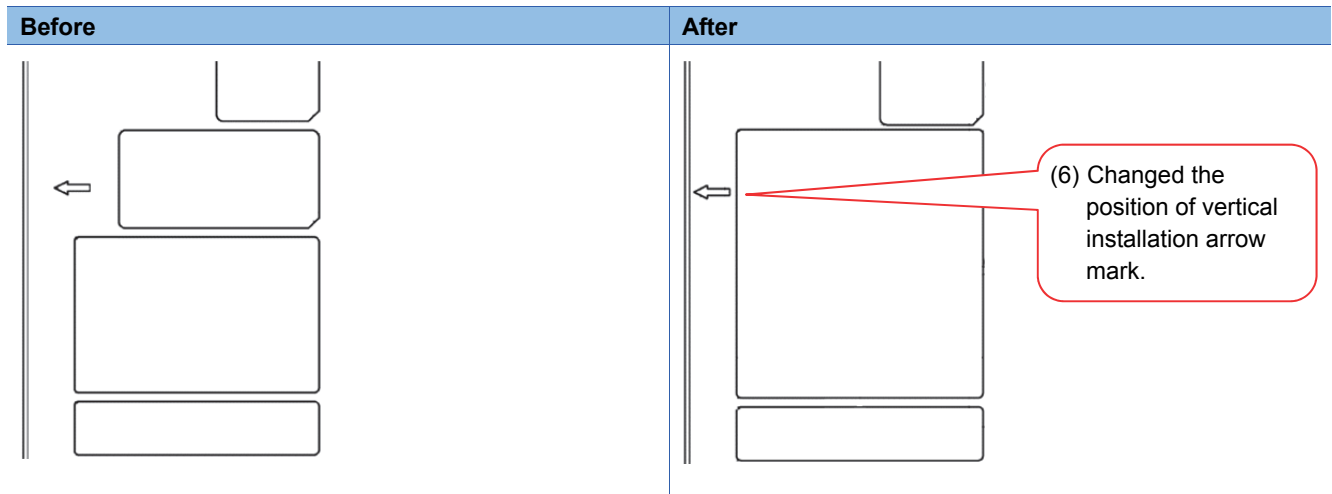

**1.3 Rear case of GT2104-RTBD, GT2104-PMBD and GT2103-PMBD**

(7) The CC-Link IE Field Basic logo has been added to the rear case of GT2104-RTBD, GT2104-PMBD and GT2103-PMBD.

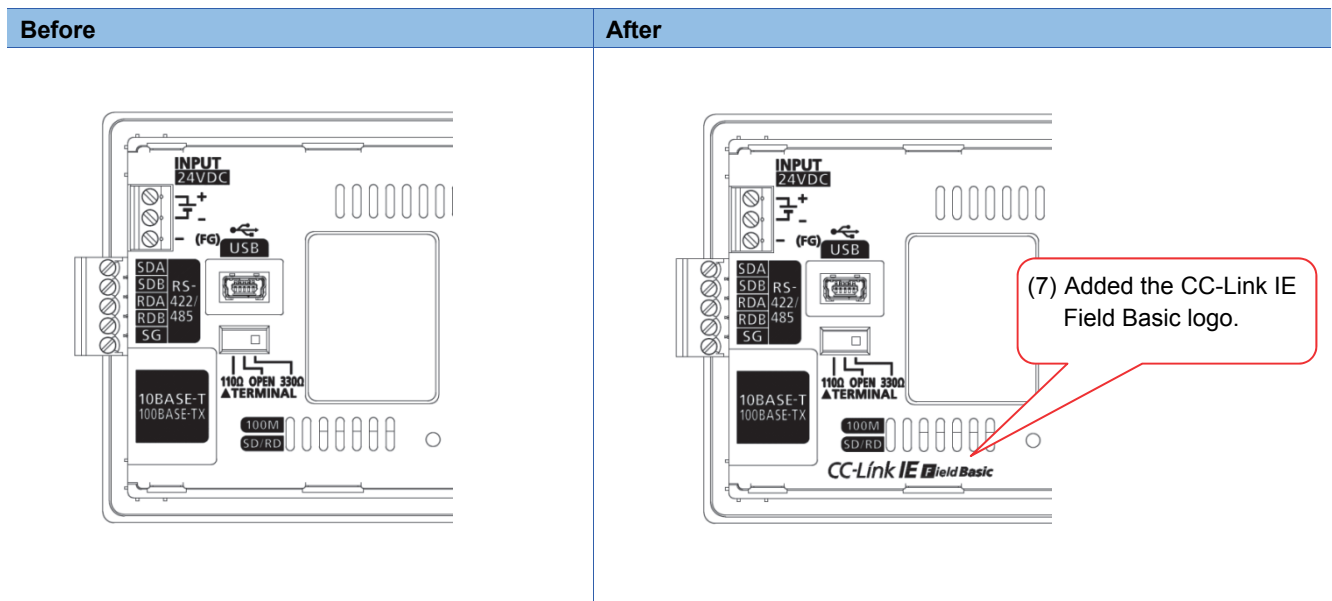

**2. Target Model**

The following shows the target models.

For the details of (1) to (7) in the header part, refer to 1. Details of Change.

○: Changed, -: Not changed

Target model			Details of change						
			(1)	(2)	(3)	(4)	(5)	(6)	(7)
GOT	GT27 model	GT2715-XTBA	○	○	○	○	○	-	-
		GT2715-XTBD	○	○	○	○	○	-	-
		GT2712-STBA	○	○	○	○	○	-	-
		GT2712-STBD	○	○	○	○	○	-	-
		GT2712-STWA	○	○	○	○	○	-	-
		GT2712-STWD	○	○	○	○	○	-	-
		GT2710-STBA	○	○	○	○	○	-	-
		GT2710-STBD	○	○	○	○	○	-	-
		GT2710-VTBA	○	○	○	○	○	-	-
		GT2710-VTBD	○	○	○	○	○	-	-
		GT2710-VTWA	○	○	○	○	○	-	-
		GT2710-VTWD	○	○	○	○	○	-	-
		GT2708-STBA	○	○	○	○	○	○	-
		GT2708-STBD	○	○	○	○	○	○	-
		GT2708-VTBA	○	○	○	○	○	○	-
		GT2708-VTBD	○	○	○	○	○	○	-
	GT2705-VTBD	○	○	○	-	○	-	-	
	GT25 model	GT2512-STBA	○	○	○	○	○	-	-
		GT2512-STBD	○	○	○	○	○	-	-
		GT2512F-VTNA	○	○	○	○	○	-	-
		GT2512F-VTND	○	○	○	○	○	-	-
		GT2510-VTBA	○	○	○	○	○	-	-
		GT2510-VTBD	○	○	○	○	○	-	-
		GT2510-VTWA	○	○	○	○	○	-	-
		GT2510-VTWD	○	○	○	○	○	-	-
		GT2510F-VTNA	○	○	○	○	○	-	-
		GT2510F-VTND	○	○	○	○	○	-	-
		GT2508-VTBA	○	○	○	○	○	○	-
		GT2508-VTBD	○	○	○	○	○	○	-
		GT2508-VTWA	○	○	○	○	○	○	-
		GT2508-VTWD	○	○	○	○	○	○	-
	GT2508F-VTNA	○	○	○	○	○	○	-	
	GT2508F-VTND	○	○	○	○	○	○	-	
	GT21 model	GT2105-QTBDS	○	-	-	-	○	-	-
		GT2105-QMBDS	○	-	-	-	○	-	-
		GT2104-RTBD	○	-	-	-	○	-	○
		GT2104-PMBD	○	-	-	-	○	-	○
		GT2104-PMBDS	○	-	-	-	○	-	-
		GT2104-PMBDS2	○	-	-	-	○	-	-
		GT2104-PMBLS	○	-	-	-	○	-	-
		GT2103-PMBD	○	-	-	-	○	-	○
		GT2103-PMBDS	○	-	-	-	○	-	-
		GT2103-PMBDS2	○	-	-	-	○	-	-
	GT2103-PMBLS	○	-	-	-	○	-	-	
	GT16 model	GT1695M-XTBA	○	○	-	-	○	-	-
		GT1695M-XTBD	○	○	-	-	○	-	-
		GT1685M-STBA	○	○	-	-	○	-	-

Target model			Details of change						
			(1)	(2)	(3)	(4)	(5)	(6)	(7)
GOT	GT16 model	GT1685M-STBD	○	○	-	-	○	-	-
		GT1675M-STBA	○	○	-	-	○	-	-
		GT1675M-STBD	○	○	-	-	○	-	-
		GT1675M-VTBA	○	○	-	-	○	-	-
		GT1675M-VTBD	○	○	-	-	○	-	-
		GT1675-VNBA	○	○	-	-	○	-	-
		GT1675-VNBD	○	○	-	-	○	-	-
		GT1672-VNBA	○	○	-	-	○	-	-
		GT1672-VNBD	○	○	-	-	○	-	-
		GT1665M-STBA	○	○	-	-	○	-	-
		GT1665M-STBD	○	○	-	-	○	-	-
		GT1665M-VTBA	○	○	-	-	○	-	-
		GT1665M-VTBD	○	○	-	-	○	-	-
		GT1662-VNBA	○	○	-	-	○	-	-
		GT1662-VNBD	○	○	-	-	○	-	-
		GT1655-VTBD	○	○	-	-	○	-	-
	GT1665HS-VTBD	○	-	-	-	-	-	-	
	GT14 model	GT1455-QTBD	○	-	-	-	○	-	-
		GT1455-QTBDE	○	-	-	-	○	-	-
		GT1450-QMBD	○	-	-	-	○	-	-
		GT1450-QMBDE	○	-	-	-	○	-	-
		GT1455HS-QTBDE	○	-	-	-	○	-	-
		GT1450HS-QMBDE	○	-	-	-	○	-	-
	GT10 model	GT1055-QSBD	○	-	-	-	○	-	-
		GT1050-QBBD	○	-	-	-	○	-	-
		GT1030-HBD	○	-	-	-	○	-	-
		GT1030-HBD2	○	-	-	-	○	-	-
		GT1030-HBL	○	-	-	-	○	-	-
		GT1030-HBDW	○	-	-	-	○	-	-
		GT1030-HBDW2	○	-	-	-	○	-	-
		GT1030-HBLW	○	-	-	-	○	-	-
		GT1030-HWD	○	-	-	-	○	-	-
		GT1030-HWD2	○	-	-	-	○	-	-
		GT1030-HWL	○	-	-	-	○	-	-
		GT1030-HWDW	○	-	-	-	○	-	-
		GT1030-HWDW2	○	-	-	-	○	-	-
GT1030-HWLW		○	-	-	-	○	-	-	
Communication unit	GT25-WLAN	○	○	-	-	○	-	-	
	GT25-FNADP	○	○	-	-	○	-	-	
	GT15-QBUS	○	○	-	-	○	-	-	
	GT15-QBUS2	○	○	-	-	○	-	-	
	GT15-75QBUSL	○	○	-	-	○	-	-	
	GT15-75QBUS2L	○	○	-	-	○	-	-	
	GT15-RS2-9P	○	○	-	-	○	-	-	
	GT15-RS4-9S	○	○	-	-	○	-	-	
	GT15-RS4-TE	○	○	-	-	○	-	-	
	GT15-RS2T4-9P	○	○	-	-	○	-	-	
	GT15-RS2T4-25P	○	○	-	-	○	-	-	
	GT15-J71LP23-25	○	○	-	-	○	-	-	
	GT15-J71BR13	○	○	-	-	○	-	-	
	GT15-J71GP23-SX	○	○	-	-	○	-	-	

Target model		Details of change						
		(1)	(2)	(3)	(4)	(5)	(6)	(7)
Communication unit	GT15-J71GF13-T2	○	○	-	-	○	-	-
	GT15-J61BT13	○	○	-	-	○	-	-
	GT01-RS4-M	○	-	-	-	○	-	-
	GT11HS-CCL	○	-	-	-	○	-	-
	GT11H-CCL	○	-	-	-	○	-	-
Option unit	GT27-MMR-Z	○	○	-	-	○	-	-
	GT27-V4-Z	○	○	-	-	○	-	-
	GT27-R2	○	○	-	-	○	-	-
	GT27-R2-Z	○	○	-	-	○	-	-
	GT27-V4R1-Z	○	○	-	-	○	-	-
	GT27-ROUT	○	○	-	-	○	-	-
	GT27-ROUT-Z	○	○	-	-	○	-	-
	GT15-PRN	○	○	-	-	○	-	-
	GT16M-MMR	○	○	-	-	○	-	-
	GT16M-V4	○	○	-	-	○	-	-
	GT16M-R2	○	○	-	-	○	-	-
	GT16M-V4R1	○	○	-	-	○	-	-
	GT16M-ROUT	○	○	-	-	○	-	-
	GT15-CFCD	○	○	-	-	○	-	-
	GT15-CFEX-C08SET	○	○	-	-	○	-	-
	GT15-SOUT	○	○	-	-	○	-	-
	GT15-DIOR	○	○	-	-	○	-	-
	GT15-DIO	○	○	-	-	○	-	-
Option	GT10-LDR	○	-	-	-	-	-	-
Cable	A9GT-QCNB	○	○	-	-	○	-	-
	GT16H-CNB-42S	○	-	-	-	○	-	-
	GT16H-CNB-37S	○	-	-	-	-	-	-

**3. Schedule**

The change will be made sequentially from the April 2017 production.  
There may be cases where both the former and new products exist in the distribution stage.

**REVISIONS**

Version	Print Date	Revision
-	February 2017	- First edition
A	March 2017	- Models have been added to "2. Target Model".